



# Model 6101/6102



Doc: CH-6101/02

June 2009

## Air operated wafer pattern butterfly valve

Wafer pattern butterfly valve with stainless steel disc (see below for liner), fitted with CH-air 'A' type pneumatic actuator. Supplied assembled and dry bench function tested. Minimum of 80 psi (5.5 bar) air supply pressure to the actuator is required.

- 6101E EPDM liner with double acting actuator
- 6102E EPDM liner with spring return actuator
- 6101N NBR liner with double acting actuator
- 6102N NBR liner with spring return actuator

With EPDM, the valve is WRAS approved.

### Applications:

Water and most non-corrosive media, subject to compatibility with wetted parts in contact with media. Actuators sized on a maximum differential pressure of 10 bar wet service, if the intended duty is above this differential, or dry (air or gas) call to check actuator sizing as a larger output actuator may be required.

Maximum working temperature of assembly is +90C. If the intended duty is at a higher temperature than this, contact us for information on high temperature liner options.

### Valve Specifications:

Body	Cast iron
Disc	Stainless steel
Liner	Standard is EPDM or NBR (others available)
Pressure rating	DN 50-150 16 bar, Rest 10 bar . (16 bar valves available but may be from different manufacturer)
Valve temp limits	-20 to +90°C
Actuator temp limits	-20 to + 70°C

### Accessories:

Solenoid control:

This provides electrical control of the valve. The air is constantly supplied to the solenoid which in turn controls the air to and from the actuator. The solenoid direct mounts to the actuator using the actuator's Namur connection.

Position Confirmation:

Remote end of travel confirmation can be provided by adding a top mounted limit switch box. A variety of switch options and housings are available. See our LSB range for details.

Position control:

The standard on/ off function can be converted to modulating function, using either a 3-15psi or 4-20mA control signal, by adding a pneumatic or electro-pneumatic positioner. See our YT range for details.



### Quick guide to the CH-air A Type actuator standard features :

*Robust rack and pinion construction*

*High accuracy machining of components*

*ATEX Ex II 2 GD approved for use in hazardous areas*

*CE Approved*

*Guaranteed for 1,000,000 cycles*

*Balanced air & spring strokes in spring return version*

*Safe to dismantle for routine maintenance*

*Compliant with all actuator standards*

*Accessories are easy to mount*

*Hard anodised aluminium body*

*ENP coated option (Extra cost)*

*Teflon® coated option (Extra cost)*

*Stainless steel version (Extra cost)*



# Model 6101/6102



Doc: CH-6101/02

June 2009

## Air operated wafer pattern butterfly valve - Dimensions (to nearest mm)

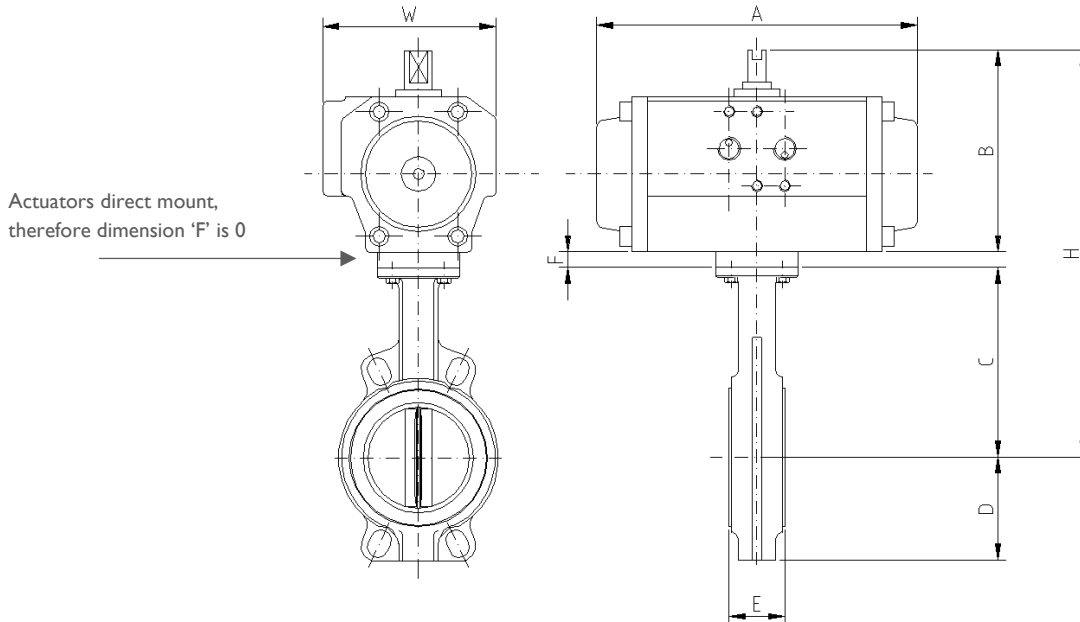

Double Acting									
	Model	A	B	C	D	E	H	W	Kilos
2"	CH063	156	103	126	84	43	229	86	3.9
2 1/2"	CH063	156	103	134	93	46	237	86	4.6
3"	CH063	156	103	157	104	46	260	86	5.7
4"	CH075	210	120	167	115	52	287	94	8.2
5"	CH075	210	120	180	127	56	300	94	9.9
6"	CH100	281	145	203	150	56	348	120	15.4
8"	CH100	281	145	228	176	60	373	120	19.0
10"	CH115	310	172	266	212	68	438	134	31.8
12"	CH125	362	172	291	237	78	463	141	43.5
Spring Return									
2"	CH063SR	156	103	126	84	43	229	86	4.0
2 1/2"	CH063SR	156	103	134	93	46	237	94	5.3
3"	CH075SR	210	120	157	104	46	277	94	7.4
4"	CH085SR	228	130	167	115	52	297	104	10.0
5"	CH100SR	281	145	180	127	56	325	120	13.8
6"	CH125SR	362	185	203	150	56	388	141	23.8
8"	CH145SR	390	205	228	176	60	433	163	32.3
10"	CH160SR	462	196	266	212	68	462	176	41.2
12"	CH180SR	474	270	291	237	78	561	196	68.3

Sizes 1" ~ 1 1/2", and above  
12" are available on request

Subject to alteration without notice. Uncontrolled copy, not subject to automatic updates