



Model 64I 1/2C (Carbon)

Model 64I 1/2S (Stainless)



Doc: CH-64I 1/02

Nov 2008

Air operated wafer pattern high performance butterfly valve

Wafer pattern high performance butterfly valve with double eccentric stainless disc and PTFE (or Inconel) seat, fitted via stainless steel mounting kit with CH-air 'A' type pneumatic actuator. Supplied assembled and dry bench function tested. Minimum of 80 psi (5.5 bar) air supply pressure to the actuator is required.

- 6211 With double acting actuator
- 6212 With spring return actuator

Applications:

Water and most non-corrosive media, subject to compatibility with wetted parts in contact with media. Actuators sized on a maximum differential pressure of 10 bar wet service, if the intended duty is above this differential, or dry (air or gas) call to check actuator sizing as a larger output actuator may be required. Can be used on saturated steam. Maximum working temperature of assembly is +200C for the PTFE seated valve, +450C for the metal seated version (Inconel seat). If the intended duty is at a temperature above +180C, contact us for information on high temperature mounting bracket options.

Valve Specifications:

Body	Suffix C = Carbon steel Suffix S = Stainless steel
Disc	Stainless steel
Liner	RPTFE or Inconel
Pressure rating	Up to DN150 40 bar DN200 + 25 bar
Valve temp limits	-40 to +450°C
Actuator temp limits	-20 to + 80°C

Accessories:

Solenoid control:

This provides electrical control of the valve. The air is constantly supplied to the solenoid which in turn controls the air to and from the actuator. The solenoid direct mounts to the actuator using the actuator's Namur connection.

Position Confirmation:

Remote end of travel confirmation can be provided by adding a top mounted limit switch box. A variety of switch options and housings are available. See our LSB range for details.

Position control:

The standard on/ off function can be converted to modulating function, using either a 3-15psi or 4-20mA control signal, by adding a pneumatic or electro-pneumatic positioner. See our YT range for details.



Quick guide to the CH-air A Type actuator standard features :

Robust rack and pinion construction

High accuracy machining of components

ATEX Ex II 2 GD approved for use in hazardous areas

CE Approved

Guaranteed for 1,000,000 cycles

Balanced air & spring strokes in spring return version

Safe to dismantle for routine maintenance

Compliant with all actuator standards

Accessories are easy to mount

Hard anodised aluminium body

ENP coated option (Extra cost)

Teflon® coated option (Extra cost)

Stainless steel version (Extra cost)



Model 6211/6212



Doc: CH-6411/02

Nov 2008

Air operated high performance wafer pattern butterfly valve with kit
- Dimensions (to nearest mm)

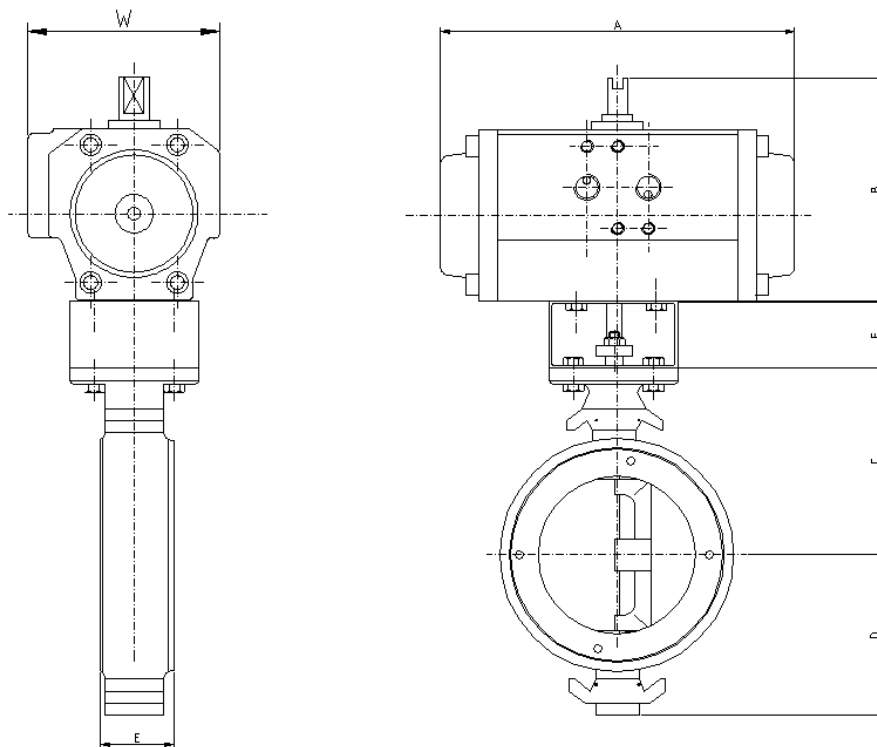

Dimensions remain unchanged for all versions (on-off, failsafe & modulating)

	Model	A	B	C	D	E	F	H	W	Kilos
2"				133	99	43				
2 1/2"				133	99	43				
3"				142	113	46				
4"				158	124	52				
5"				181	140	56				
6"				195	154	60				
8"				225	191	68				
10"				268	222	78				
12"				300	255	92				

ON APPLICATION
 (Torque figures and therefore actuator sizes vary with different operating pressures, and with either RTFE or Inconel seat)